

Butter Wheel unit shown

# Vertical Contact Toaster

## Model VCTM-2 owner's manual

**Manufacturing Numbers:**

9210914, 9210916

9210959, 9210960 & 9210983



# VERTICAL CONTACT TOASTER

## OWNER INFORMATION

### Table of Contents

Owner Information .....	2
Specifications .....	3
Important Safety Information .....	4
Installation.....	5
Operation.....	7
Maintenance.....	10
Troubleshooting .....	17
Replacement Parts .....	19
Wiring Diagram.....	25
Notes.....	26

### General

This manual provides the safety, installation, and operating procedures. We recommend that all information contained in this manual be read prior to installing and operating the unit.

This unit is manufactured from the finest materials available, assembled to our strict quality standards, and tested at the factory to ensure dependable trouble-free operation.

### Warranty Information

Please read the full text of the Limited Warranty printed on the front cover of this manual.

If the unit arrives damaged, contact the carrier immediately and file a damage claim with them. Save all packing materials when filing a claim. Freight damage claims are the responsibility of the purchaser and NOT covered under warranty.

The warranty does NOT extend to:

- Damages caused in shipment or damage as result of improper use.
- Installation of electrical service.
- Installation, calibration, or adjustment.
- Normal maintenance outlined in this manual.
- Consumable parts such as Egg Rings, gaskets, rubber feet, labels, O-rings, light bulbs, etc.
- Malfunction resulting from improper service or maintenance.
- Damage caused by improper installation, abuse, or careless handling.
- Damage from moisture getting into electrical components.
- Damage from tampering with, removal of, or changing any preset control or safety device.
- Damage caused by parts or components not provided by Antunes.

### Service/Technical Assistance

If you experience any problems with the installation or operation of your unit, contact Antunes Technical Service at +1-877-392-7854 (toll free).

Fill in the information below and have it handy when calling Antunes Technical Service for assistance. The serial number is on the specification plate located on the side of the unit.

Purchased From: \_\_\_\_\_

Date of Purchase: \_\_\_\_\_

Model No.: \_\_\_\_\_

Serial No.: \_\_\_\_\_

Mfg. No.: \_\_\_\_\_

Use only genuine Antunes replacement parts in this unit. Use of replacement parts other than those supplied by the manufacturer will void the warranty.

**IMPORTANT!** Keep these instructions for future reference. If the unit changes ownership, be sure this manual accompanies the equipment.

# VERTICAL CONTACT TOASTER

## SPECIFICATIONS

### Electrical Ratings & Plug Configurations

Model & Mfg. Number	Volts	Watts	Amps	Hertz	Plug Description
VCTM-2 9210914 (Butter Wheel)	208-230	3100	14.9/13.4	50/60	IEC-309 Pin & Sleeve, 16 Amp., 250 Volt
VCTM-2 9210916 (No Butter Wheel)					
VCTM-2 9210959 (No Butter Wheel)					
VCTM-2 9210960 (No Butter Wheel)					
VCTM-2 9210983 (No Butter Wheel)					

### Dimensions

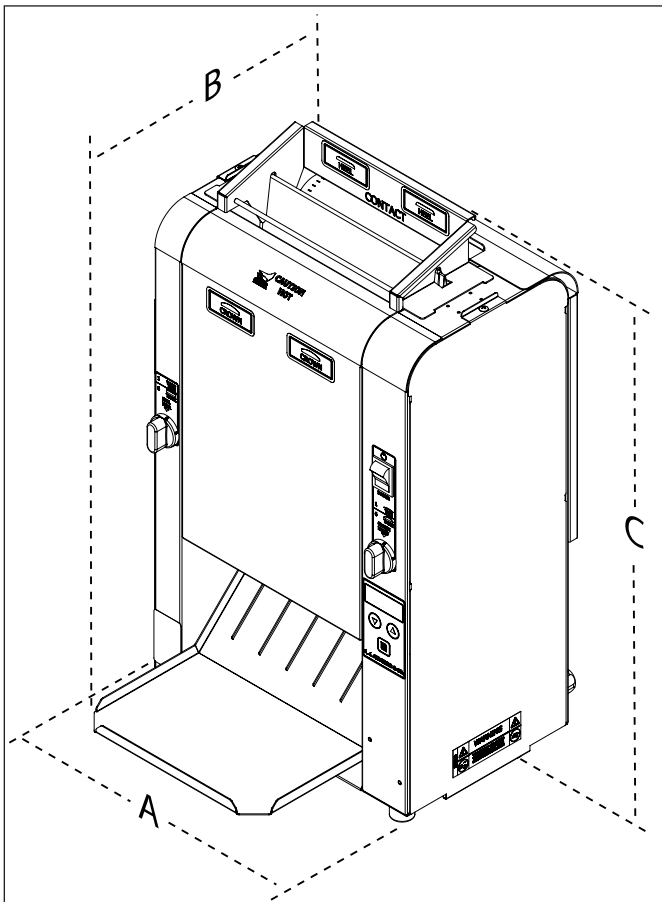

Model & Mfg. No.	Width (A)	Depth (B)	Height (C)
VCTM-2 9210914 (Butter Wheel)	14" (356 mm)	15 1/2" (394 mm)	25 1/2" (648 mm)
VCTM-2 9210916 (No Butter Wheel)			
VCTM-2 9210959 (No Butter Wheel)			
VCTM-2 9210960 (No Butter Wheel)			
VCTM-2 9210983 (No Butter Wheel)			

# VERTICAL CONTACT TOASTER

## IMPORTANT SAFETY INFORMATION

In addition to the warnings and cautions in this manual, use the following guidelines for safe operation of the unit.

- Read all instructions before using equipment.
- For your safety, the equipment is furnished with a properly grounded cord connector. Do NOT attempt to defeat the grounded connector.
- Install or locate the equipment only for its intended use as described in this manual. Do NOT use corrosive chemicals in and/or on this equipment.
- Do NOT operate this equipment if it has a damaged cord or plug, if it is not working properly, or if it has been damaged or dropped.
- This equipment should be serviced by qualified personnel only. Contact Antunes Technical Service for adjustment or repair.
- Do NOT block or cover any openings on the unit.
- Do NOT immerse cord or plug in water.
- Keep cord away from heated surfaces.
- Do NOT allow cord to hang over edge of table or counter.
- Do NOT clean this appliance with a water jet.

The following warnings and cautions appear throughout this manual and should be carefully observed.

- Turn the unit off, wait for the cool-down procedure to complete its cycle, and disconnect the power cord before performing any service or maintenance on the unit.

**NOTE: Turning off the power switch does NOT turn off all power to the unit. When the unit is plugged in and turned off, an LED light flashes to indicate that the power cord is plugged in.**

### **WARNING**

**To avoid possible personal injury and/or damage to the unit, all inspections, tests, and repair of electrical equipment should be performed by QUALIFIED SERVICE PERSONNEL. The unit MUST be completely shut down and unplugged before any internal servicing, except when electrical tests are required. Use extreme care during electrical circuit tests. Live circuits will be exposed.**

### **CAUTION**

**All electrical connections must be in accordance with local electrical codes and any other applicable codes.**

### **CAUTION**

**Bread may burn. Therefore toasters must not be used near or below curtains or other combustible walls and materials. Failure to maintain safe operating distances may cause discoloration or combustion.**

### **CAUTION**

**NEVER unplug the power cord while the unit is running! Use the proper shutdown procedure before unplugging the power cord.**

### **WARNING**

**ELECTRICAL SHOCK HAZARD. FAILURE TO FOLLOW THE INSTRUCTIONS IN THIS MANUAL COULD RESULT IN SERIOUS INJURY OR DEATH.**

- Electrical ground is required on this appliance.
- Do NOT modify the power supply cord plug. If it does not fit the outlet, have a proper outlet installed by a qualified electrician.
- Do NOT use an extension cord with this appliance.
- The toaster should be grounded according to local electrical codes to prevent the possibility of electrical shock. It requires a grounded receptacle with separate electrical lines, protected by fuses or circuit breaker of the proper rating.
- Check with a qualified electrician if you are unsure if the appliance is properly grounded.

## INSTALLATION

### Unpacking

1. Remove unit and all packing materials from shipping carton.
2. Open the included large box. It should contain the following (See Figure 2):
  - Bun Chute
  - Butter Wheel and Pan (Mfg. No. 9210914)
  - Bun Feeder
  - Two guttered Release Sheets
  - Platen Cleaning Tool
  - Owner's Manual
  - Maintenance Card
3. Remove all shipping tape and protective coverings from the unit and parts.

**NOTE: Missing or damaged parts? Contact Antunes Customer Service at +1-877-392-7856 (toll free).**

### Equipment Setup

Before placing the toaster into service, pay attention to the following guidelines:

- Make sure power to the unit is off and the toaster is at room temperature.
- Do NOT block or cover any openings on the unit.
- Do NOT immerse cord or plug in water.
- Keep cord away from heated surfaces.
- Do NOT allow cord to hang over edge of table or counter.
- Connect the unit to the proper power supply. Refer to the specification plate for proper voltage.

### Assembling the Unit

**NOTE: The factory has pre-installed a Release Sheet over the Platen (Figure 2). Verify that it is properly in place before proceeding.**



**CAUTION**

**Failure to use Release Sheets may result in damage to the unit and loss of warranty coverage.**

### INSTALLING BUTTER WHEEL ASSEMBLY (MFG. NO. 9210914 ONLY)

1. For Butter Wheel units, remove the Butter Wheel and Pan from box.
2. Install the Pan over the front edge of the Heat Shield and place the Butter Roller in Pan and engage into gear case (Figure 2).
3. Fill the Butter Pan with Butter before toasting.

### INSTALLING THE BUN CHUTE

1. If the unit is on, be sure to put on heat resistant gloves.
2. Insert the Bun Chute through the front of the unit according to Figure 1.
3. Hang the back of the Bun Chute on the rear Conveyor Cover hinge. When properly installed, the Bun Chute supports will be flush against the front of the unit (Figure 1).

**NOTE: You may need to stand to the side of the unit to guide the Bun Chute into place from the front and rear using both hands.**

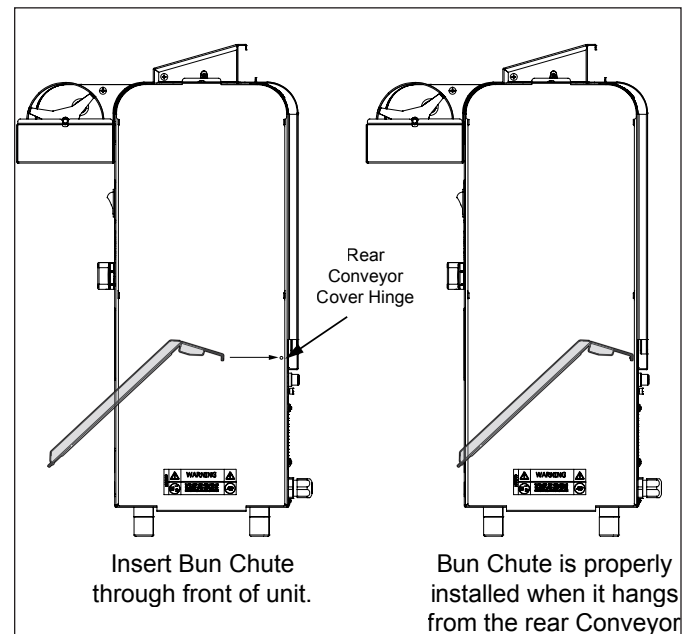

**Figure 1. Installing Bun Chute**

**IMPORTANT: Make sure Heat Shield assembly is activating the Conveyor Interlock Switch (Figure 2). The conveyors will not rotate unless the Heat Shield is in place and Conveyor Interlock Switch is activated.**

# VERTICAL CONTACT TOASTER

## INSTALLATION (CONTINUED)

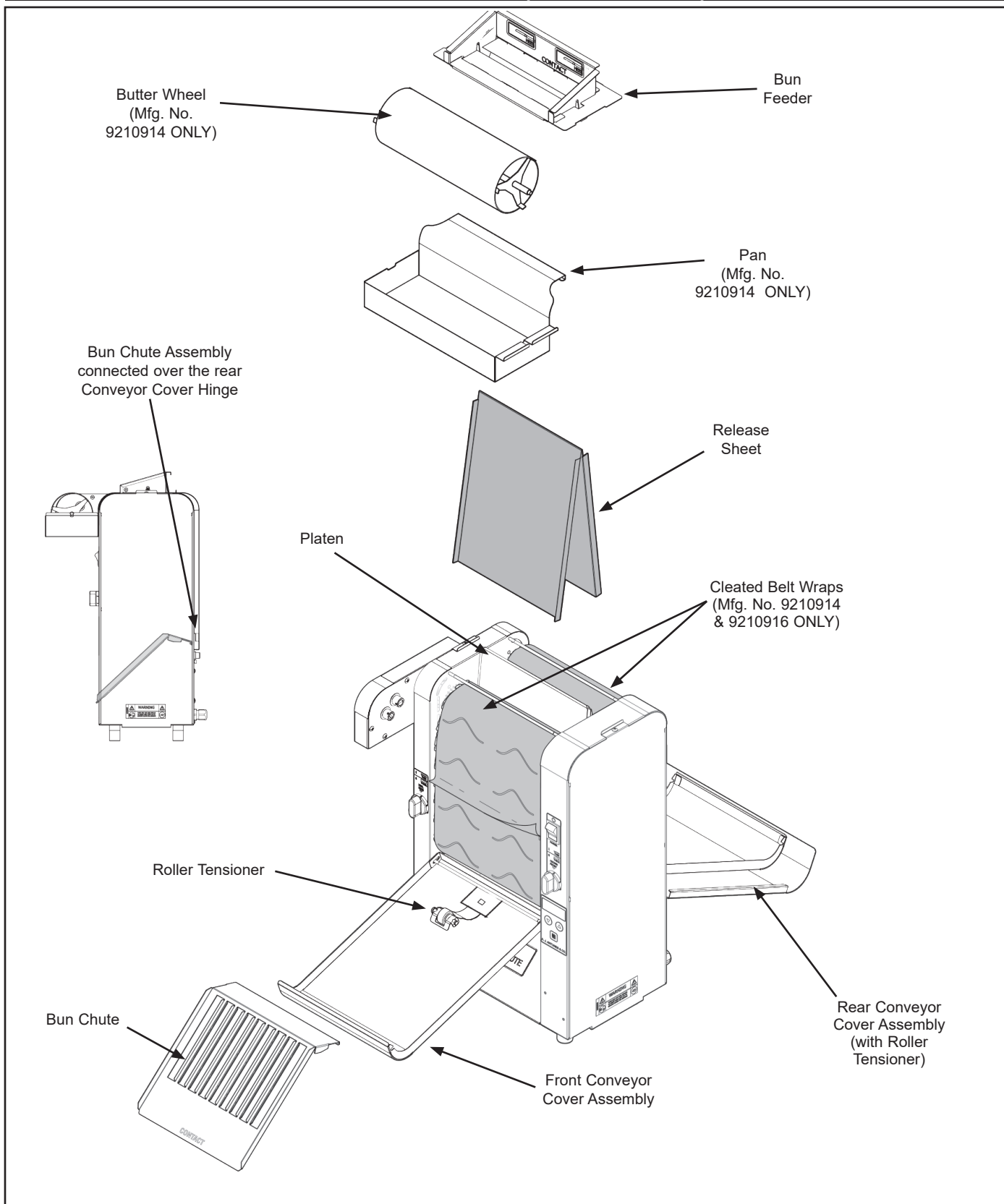

Figure 2. Components

# VERTICAL CONTACT TOASTER

## OPERATION

### Operating Instructions

1. Set the Bun Thickness Adjustment Controls (Figure 3).

**NOTE:** Your individual customer or store requirements are the deciding factor on the finished product, not the Bun Thickness setting.

**NOTE:** The default Bun Thickness settings are 2 for Crown Front and 2 for Heel Rear, but settings are adjustable from 1-6. It is acceptable to adjust the Bun Thickness setting as needed to achieve the desired quality toast and bun compression.

2. Turn the power on and wait until the display reads USE before proceeding.

**NOTE:** The display (Figure 3) flashes “LO” during warm-up. “USE” appears when the toaster is ready for use.

3. Fill the Butter Pan (Mfg. No. 9210914 only).
4. Slide buns across the rotating Butter Wheel with the cut face down (Mfg. No. 9210914 only).
5. Drop buns into the Bun Feeder. Insert buns so they face the center platen. The cut sides of heel and crown must face each other and slide against the Release Sheet with Crowns inserted in the front and Heels inserted in the rear.
6. Toasted buns drop onto the Bun Chute (Figure 3).
7. Test at least 4 buns before putting the toaster into service.

### Default Settings

#### RECOMMENDED TEMPERATURES

Refer to the table below for recommended settings.

Mfg. Number	Platen A Setting	Platen B Setting	Speed Setting	Pass Through Time
9210916 (No Butter Wheel)	293° C (560° F)	218° C (424° F)	1400	22 Seconds
9210914 (Butter Wheel)				
9210959 (No Butter Wheel)				
9210960 (No Butter Wheel)				
9210983 (No Butter Wheel)				

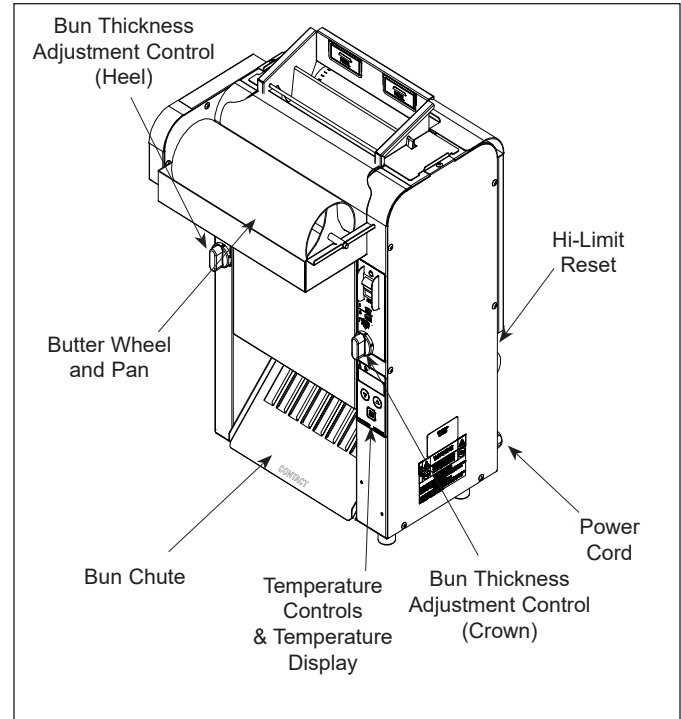

Figure 3. VCTM-2 Toaster

### Light/Dark Setting

The toaster has a Light/Dark adjustment setting that allows you to adjust the toast quality as the toaster is running.

While the toaster is in USE mode, press the UP or Down arrow buttons to adjust the Light/Dark setting.

The default setting is D0.

Light 10 is the lightest setting

Dark 10 is the darkest setting.



# VERTICAL CONTACT TOASTER

## OPERATION (CONTINUED)

### Viewing Settings

To view the toaster settings press and hold the Menu button (Figure 4) for approximately 5 seconds. The unit beeps and shows the settings in the following order, displaying the value in column 1 first, then the actual setting.

Display Shows	Setting Description
°A - ° F	A Platen current temperature*
b° - ° F	B Auxiliary heater current temperature*
SPEd	Speed of belts
Unit	Current temperature Unit
Er	Error Code
Et - d	Elapsed Time of toaster usage
Int ° F	Internal toaster Temperature
PL	Power Line Voltage

\* The first circles shown in these values represent the Platen indicator lights. The temperature unit will be shown as ° F or ° C depending on the Unit setting.

### Changing Settings

The only settings that can be changed on the toaster are:

- A Platen setpoint temperature
- B Platen setpoint temperature
- Speed
- Unit

To change these settings, follow these steps.

1. With the toaster turned off, press and hold the Menu button and turn the toaster on. Continue holding the Menu button until the unit beeps and EnA appears on the display. Release the Menu button.
2. Press the Menu button again. The toaster shows °A - ° F (A Platen) and then shows the current A Platen setpoint value. Use the ▲ and ▼ buttons to change the value as needed.
3. Press the Menu button to move to the B Platen setting. Edit as needed.
4. Press the Menu button to move to the SPED (Speed setting). Edit as needed.
5. Press the Menu button to move to the Unit setting. Edit as needed.

The settings are saved each time you press the Menu button and move to the next value. The toaster exits programming mode after 30 seconds of inactivity.

### Factory Reset

To reset the toaster to the original factory settings:

1. Turn the toaster off.
2. Press and hold both the ▲ and ▼ buttons and turn the toaster on, continuing to hold the ▲ and ▼ buttons until the unit beeps and FR (Factory Reset) appears on the display.
3. Release the buttons.

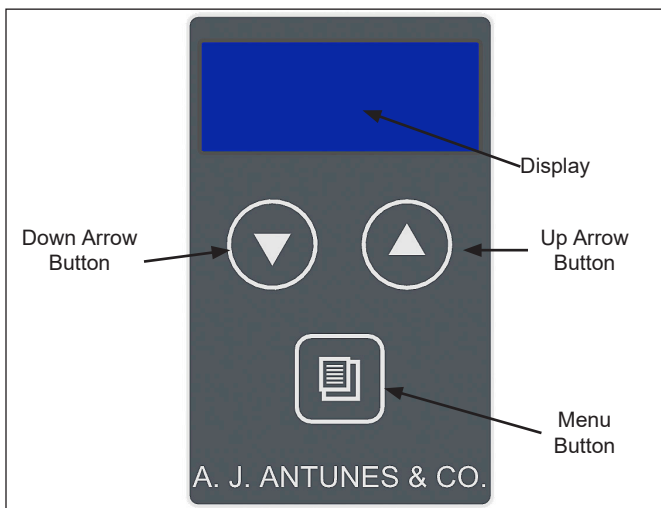

Figure 4. Control Panel and Display

### Hi-Limit Reset Button

A Hi-Limit Control turns off power to the unit if it overheats. To reset the control, allow the unit to cool, then locate the Reset Button at the rear of the unit. Remove the black protective cap, press the Reset Button, and reinstall the protective cap (Figure 3).

**NOTE: If the Hi-Limit requires continuous resetting, contact Antunes Technical Service.**



## OPERATION (CONTINUED)

### Fault Codes

The table below describes error codes and the corrective action.

Error #	Cause/Description	Corrective Action
1	Cannot communicate with thermocouple A/D converter (U3). Potentially failed PC Board Component.	Turn unit off and back on again. If error persists, this may indicate a failed PC Board component. Contact Antunes Technical Service for assistance.
2	Cannot detect power line zero cross. Potentially failed PC Board Component.	
3	Calibration check sum. Potentially failed PC Board Component.	
4	Microprocessor I2C buss communications error. Potentially failed PC Board Component.	
5	Microprocessor I2C buss communications error. Potentially failed PC Board Component.	
6	Cannot communicate with Fram (U9). Potentially failed PC Board Component.	
7	Cannot communicate with TMP75 (board temp sensor) (U4). Potentially failed PC Board Component.	
8	On-board voltage reference in thermocouple circuit failed (U1). Potentially failed PC Board Component.	
9	Not used.	Not Used
10	Board temp sensor exceeds 158° F.	Verify vents on toaster are unblocked and not near other heated appliances. If error persists, contact Antunes Technical Service for assistance.
11	Main Hi Limit tripped.	Reset Hi Limit, turn unit off and back on again. If error persists, contact Antunes Technical Service for assistance.
12	Cannot measure power line voltage Failed on-board transformer used for power control (T1).	Turn unit off and back on again. If error persists, contact Antunes Technical Service for assistance.
13	USB port voltage below 4.5V - Something plugged into USB port.	Remove anything connected to the USB port, turn unit off and back on again. Turn unit off and back on again. If error persists, contact Antunes Technical Service for assistance.
14	Main platen has not reached set point within 20 minutes.	Turn unit off and back on again. If error persists, contact Antunes Technical Service for assistance.
15	Main platen has exceeded 650° F.	
16	Main platen has fallen 50°F below set point after Ready state.	
17	Main thermocouple failed (open).	
18	Aux has fallen 50°F below set point after Ready state; will clear from display if temperature recovers; error is logged into memory.	Make sure front and rear covers are in proper position. Turn unit off and back on again. If error persists, contact Antunes Technical Service for assistance.
19	Auxiliary Heater exceeds 525° F.	
20	Auxiliary Heater does not reach set point within 20 minutes.	
21	Auxiliary thermocouple failed (open).	Turn unit off and back on again. If error persists, contact Antunes Technical Service for assistance.
22	Auxiliary Hi Limit (hardware circuit trips at 550°F which turns off contactor; ER22 then shows within 2 seconds).	Turn unit off and back on again. If error persists, contact Antunes Technical Service for assistance.
23	Cannot communicate with motor microprocessor (U13).	Turn unit off and back on again. If error persists, this may indicate a failed PC Board component. Contact Antunes Technical Service for assistance.
24	Motor stopped.	Make sure no buns are stuck in conveyors or any obstructions around conveyors. Turn unit off and back on again. If error persists, contact Antunes Technical Service for assistance.

Figure 5. Fault Codes Table

# VERTICAL CONTACT TOASTER

## MAINTENANCE

### ⚠ WARNING ⚠

Turn the power off, unplug the power cord before performing any service or maintenance.

### Daily Cleaning

1. **Turn unit off.** Turn the power OFF, unplug the power cord, and clean the release sheet and belts wraps while they are warm. Toaster surfaces are hot!

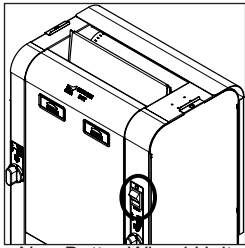

Non-Butter Wheel Unit

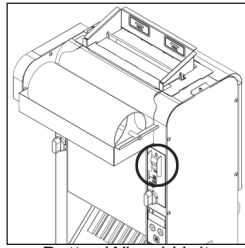

Butter Wheel Unit

2. **Remove accessories.** Put on heat-resistant gloves. Remove the Heat Shield and Bun Chute. Remove Butter Wheel Assembly if present.

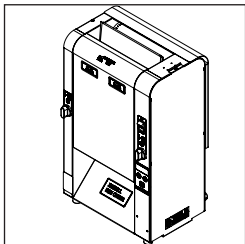

Non-Butter Wheel Unit

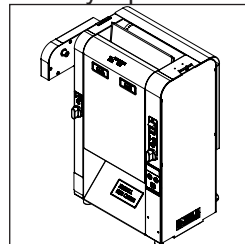

Butter Wheel Unit

3. **Wash accessories.** Take the Heat Shield and Bun Chute to the sink and wash, rinse, and sanitize. Wash the Butter Wheel Roller and Pan if present.

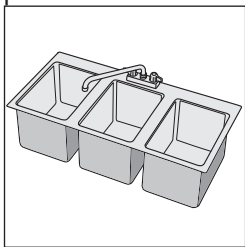

4. **Remove release sheet.** Remove the release sheet and place it on a clean, flat dry surface.

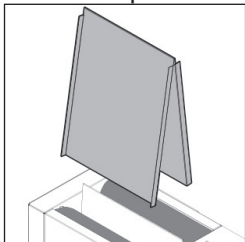

5. **Inspect release sheet and belt wraps.** Inspect the release sheet and belt wraps. Replace if they are torn, damaged, or have excessive burnt butter buildup.

6. **Clean release sheet.** Spray the silver side of the release sheet with Sink Detergent Solution and wipe with a clean, sanitizer-soaked towel. Rinse the silver side of the Release Sheet with a separate, clean sanitizer-soaked towel.

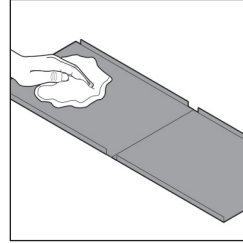

7. **Clean release sheet.** Flip the release sheet over and spray the black side with Sink Detergent Solution and wipe with a clean, sanitizer-soaked towel. Rinse the black side of the release sheet with a separate, clean sanitizer-soaked towel. Discard the soiled towel into the soiled towel bucket after use. Allow to air dry.

8. **Clean front belt wrap.** Open the front conveyor cover and firmly wipe the belt wrap from left to right and top to bottom with a clean, sanitizer-soaked towel sprayed with an approved Degreaser solution. Rinse the belt wrap from left to right and top to bottom with a separate, clean sanitizer-soaked towel.

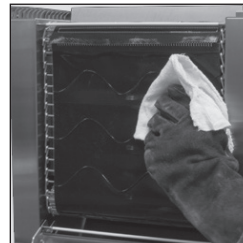

## MAINTENANCE (CONTINUED)

9. **Clean rear belt wrap.** Close the front conveyor cover, open the rear conveyor cover and clean the belt wrap following step 9. Discard the soiled towels into the soiled towel bucket after use.

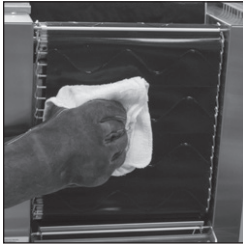

10. **Rotate belt wraps.** Close the rear conveyor cover. Reinstall the clean heat shield, plug in the power cord, turn the unit, count 40 seconds, then turn the unit OFF and unplug the unit.
11. **Clean rear belt wrap.** Open the rear conveyor cover again and clean the newly exposed section of the belt wrap from left to right and top to bottom with a clean, sanitizer-soaked towel sprayed with an approved Degreaser solution. Rinse the belt wrap from left to right and top to bottom with a separate, clean, sanitizer-soaked towel.
12. **Clean front belt wrap.** Close the rear conveyor cover, open the front conveyor cover and clean the belt wrap following step 11. Discard the soiled towels into the soiled towel bucket after use. Close the front conveyor cover.
13. **Clean exterior.** Wipe down the exterior of the toaster with a clean, sanitizer-soaked towel sprayed with an approved Degreaser solution. Rinse the exterior toaster with a separate, clean sanitizer-soaked towel. Discard the towel into the soiled towel bucket after use.
14. **Install release sheet.** The release sheet has folded gutters to prevent butter migration onto the platen. Prior to installing the sheet, fold the gutters 90 degree if needed. Install the release sheet by draping it over both sides of the platen with the black side facing out.

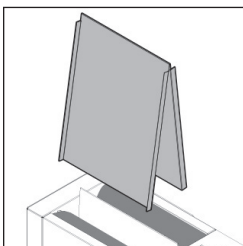

**NOTE: The release sheet is not reversible, black side should always be facing out.**

15. **Re-install accessories.** Install the Bun Chute through the front of the toaster. Hang the back of the Bun Chute on the rear Conveyor Cover hinge. When properly installed, the Bun Chute supports will be flush against the front of the unit. You may need to stand to the side of the unit to guide the Bun Chute into place from the front and rear using both hands. Reinstall the Heat Shield. Install the Butter Wheel Roller into the Butter Wheel Pan and attach assembly onto the toaster. Fill the butter pan with the proper amount of butter for your restaurant.

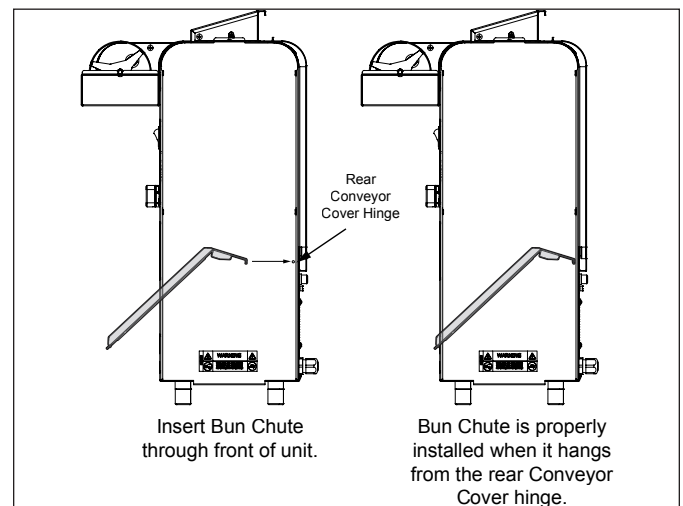

16. **Turn unit on.** Plug the toaster in and turn the power switch to ON.

# VERTICAL CONTACT TOASTER

## MAINTENANCE (CONTINUED)

### Quarterly Cleaning

1. **Turn unit off.** Turn the power OFF, unplug the power cord, and allow the unit to cool before proceeding.

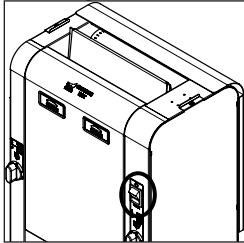

2. **Remove accessories.** Put on heat-resistant gloves and remove the Butter Wheel and Butter pan (if present), and Heat Shield and set the bun thickness compression knobs to 6 & 6.

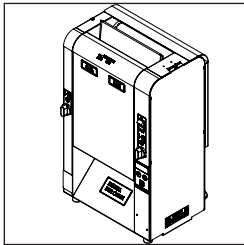

3. **Remove belt wrap pin.** Open both conveyor covers (rear and front) and pull the belt wrap pin out of the zipper.



4. **Remove and inspect the belt wraps.** Remove the belt wraps and inspect both sides of the belt wraps for damage to the flap, ribs, pin, zipper or silicone surface. Replace any damaged belts.

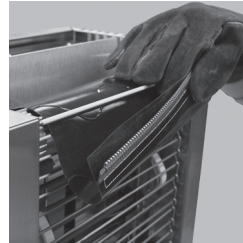

5. **Clean conveyor chains.** Clean both conveyor belt chains (rear and front) with a non-scratch scouring pad sprayed with an approved Degreaser solution. Rinse with a separate, clean, sanitizer-soaked towel.

**NOTE: Do not spray the toaster with water or cleaning product. This can damage electrical components.**

6. **Rotate conveyor chains.** Close both conveyor covers. Plug in the power cord, turn the unit on, count 22 seconds, then turn the unit OFF and unplug the unit.

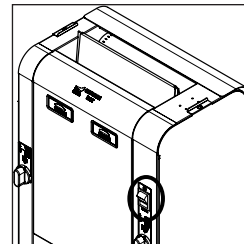

7. **Clean conveyor chains.** Open both conveyor covers again and clean the newly exposed section of the conveyor belt chains from left to right and top to bottom with a non-scratch scouring pad sprayed with an approved Degreaser solution. Rinse the belt wrap from left to right and top to bottom with a separate, clean, sanitizer-soaked towel.

Be sure to perform the steps under the sections titled **Checking the Conveyor Belt Chains** and **Checking the Roller Tensioners**.

8. **Clean belt wraps.** Wipe down the belt wraps with a clean, sanitizer-soaked towel and allow to air dry before installing.

## MAINTENANCE (CONTINUED)

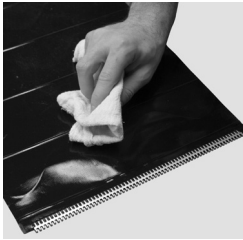

9. **Install belt wraps.** Install the belt wraps around the conveyor belt chains.

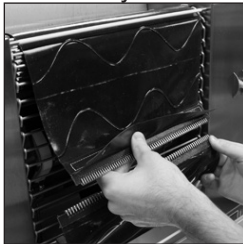

10. **Reinstall accessories.** Close the conveyor covers and reinstall the Heat Shield, Butter Wheel, and Pan (if present).

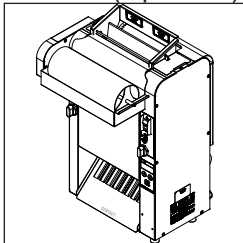

11. **Set Bun Thickness Compression Knobs.** Set the bun thickness compression knobs back to their normal settings. Your individual customer or store requirements are the deciding factor on the finished product, not the bun thickness setting. The default bun thickness settings are 2 for Crown Front and 2 for Heel Rear, but settings are adjustable from 1-6. It is acceptable to adjust the bun thickness setting as needed to achieve the desired quality toast and bun compression.
12. **Turn unit on.** Plug the toaster in and turn the power switch to ON.

# VERTICAL CONTACT TOASTER

## MAINTENANCE (CONTINUED)

### **⚠ WARNING ⚠**

Turn the power off, unplug the power cord before performing any service or maintenance.

### Replacing the Belt Wraps

**NOTE:** Depending on toaster usage and how well they are cleaned daily, Belt Wraps should last 6 months or longer .

1. Turn the power off, unplug the power cord, and allow the unit to cool before proceeding.
2. Remove the Bun Feeder, Butter Wheel and Pan (if present), and Bun Chute and set aside (Figure 2). Set the Bun Thickness Compression Knobs to 6 & 6.
3. Open both Conveyor Covers and pull the Belt Wrap Pin out of the zipper on each belt wrap (Figure 6).
4. Disconnect the clips on the inside part of the Belt Wraps from the Conveyor Belt Chain.
5. Remove and discard the old Belt Wraps.
6. Wipe the new Belt Wraps with a clean, sanitizer-soaked towel. Allow to air dry.
7. Install the new Belt Wraps around the Conveyor Belt Chains inside the Support Rods with the zipper flap exposed and hanging down (Figures 6 & 7).
8. Attach the clips on the inside part of the Belt Wraps to the Conveyor Belt Chain.
9. Align the Belt Wrap teeth evenly and connect the ends of the Belt Wraps by inserting the Belt Wrap Pin.
8. Close the Conveyor Covers, set the Bun Thickness Compression Knobs back to their normal settings and reinstall the Butter Wheel and Pan (if present), Bun Feeder, and Bun Chute.

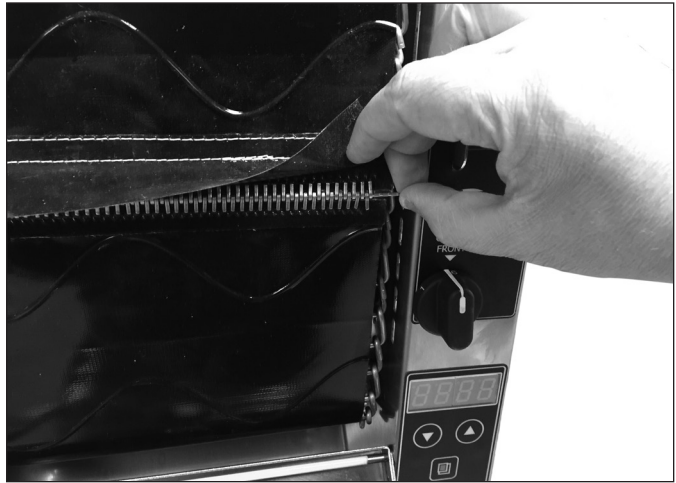

Figure 6. Installing Belt Wrap

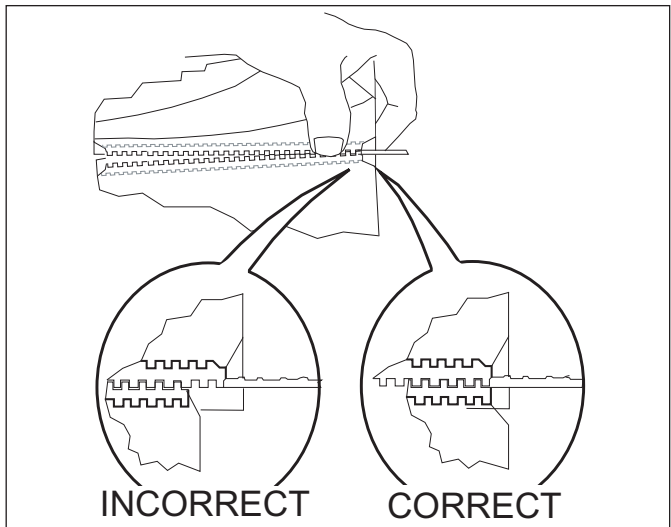

Figure 7. Aligning Belt Teeth

### **⚠ CAUTION ⚠**

Align the ends of the Belt Wrap properly (Figure 9) or the Belt Wrap may be damaged.

### **⚠ CAUTION ⚠**

Position the Belt Wrap UNDER the upper and lower support rods or damage to the unit may occur.



## MAINTENANCE (CONTINUED)

### Checking the Conveyor Belt Chains (Quarterly)

#### MEASURING CONVEYOR BELT CHAINS

1. Turn the unit off, unplug the power cord, and allow the unit to cool.
2. Remove the Bun Feeder, Butter Wheel and Pan (if present), and Bun Chute (Figure 2). Set the Bun Thickness Compression Knobs to 6 & 6.
3. Open both Conveyor Covers.
4. Remove the Belt Wraps and set aside (Figures 7 & 8).
5. Facing the toaster, locate the approximate center-point of the Conveyor Belt Chain.
6. Pull the chain away from the edge of the toaster (Figure 8).
7. Measure the distance from the frame of the unit and the chain. A U.S. Dime (1.8 cm) can be used for the measurement (Figure 8).
8. If the gap is 2 times wider than the coin or larger than 3.6 cm, remove one 1/2" link as described below.
9. Disconnect the chain by squeezing any two links together and unhook the links from each other (Figure 9). Needle-nose pliers may be used.

**NOTE: There are two small 1/2" links on each side of the Conveyor Belt Chain. The rest are large 3/4" links.**

10. Remove one 1/2" link from the chain.
11. Reassemble the chain onto the sprockets as described in the *Replacing Conveyor Belt Chains* section of this manual.
12. Measure the gap again with the coin. The coin should fit snugly between the chain and frame.
13. Check the opposite side of the toaster using the same steps.
14. When finished, reassemble the unit and return to operation.

**NOTE: If the ends of the Conveyor Belt Chain cannot be connected, remove an additional small 1/2" link and install a large 3/4" link in its place.**

#### REPLACING CONVEYOR BELT CHAINS

1. Turn the power off, unplug the power cord, and allow the unit to cool before proceeding.

2. Remove the Butter Wheel and Pan (if present), and Bun Chute and set the Compression Control Knobs to 6 & 6.
3. Open both Conveyor Covers.
4. Remove both Belt Wraps and set aside.
5. Disconnect the Conveyor Belt Chain by squeezing any two links together and unhook both ends of one link (Figure 9). Repeat on other side.
6. Place the new chain on the top sprockets with hook ends down.

**NOTE: The ends of the hooks must point down (Figure 9).**

7. Wrap the chain around the top and lower sprockets. Hook both ends together. Repeat on other side.

**NOTE: Install the Conveyor Belt Chains under the upper and lower Support Rods.**

8. If the Belt Wraps are in good condition, reinstall. Otherwise install new Belt Wraps.
9. Close the Conveyor Covers, set the Bun Thickness Compression Knobs back to their normal settings and reinstall the Butter Wheel and Pan (if present), Bun Feeder, and Bun Chute.



Figure 8. Measuring Conveyor Belt Chain

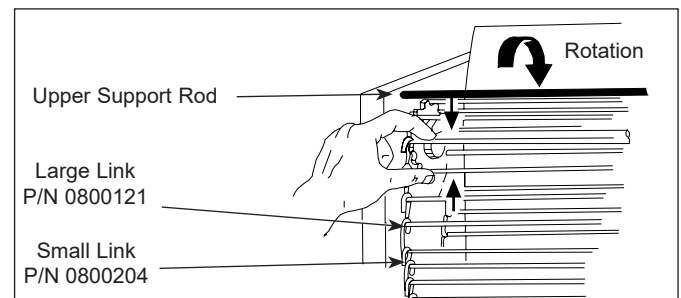

Figure 9. Removing Conveyor Belt Chain



# VERTICAL CONTACT TOASTER

## MAINTENANCE (CONTINUED)

### Checking the Roller Tensioners (Quarterly)

#### MEASURING THE ROLLER TENSIONERS

1. Measure the Roller Tensioner on both inner Conveyor Covers (Figure 10) using a U.S. Nickel.
2. The space between the inner Conveyor Cover and bottom of the Tensioner wheel should be  $13/16"$  (2.1 cm) or the height of a U.S. Nickel.
3. Adjust the tensioner as needed. Replace any damaged tensioner.

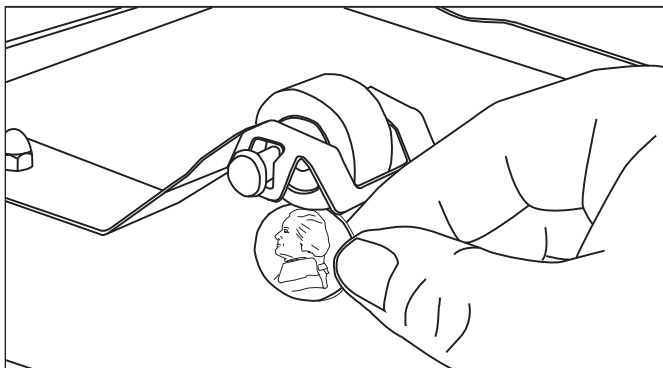

Figure 10. Measuring Roller Tensioner

#### REPLACING THE ROLLER TENSIONERS

1. Push down on retaining tab of the tensioner.
2. While keeping pressure on the retaining tab, slide the tensioner out of the guide plate.
3. Replace the tensioner by sliding the new one into the guide plate.

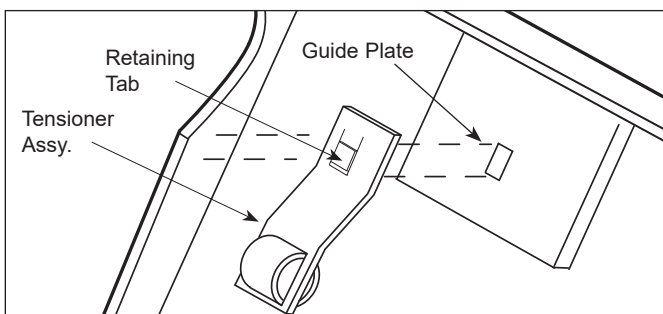

Figure 11. Replacing the Roller Tensioner

# VERTICAL CONTACT TOASTER

## TROUBLESHOOTING

Problem	Possible Cause	Corrective Action
No Control Display	Power cord not plugged in	Plug power cord into the proper electrical outlet.
	Circuit breakers turned off or tripped. Damaged electrical outlet, plug, or cord. Power switch damaged	Reset circuit breakers. If they trip again, check the power cord, plug, and outlet for damage. Contact Antunes technical service for assistance.
	Power Switch not turned on or is faulty.	Turn the unit off and then on again. If the problem persists, contact Antunes technical service for assistance.
	Faulty Transformer	
Conveyor does not rotate	Conveyor Belt/Chain has stretched. Chain skipping on sprockets.	Measure and adjust the conveyor belt chains as described in the Maintenance section of this manual.
	Loose setscrew on one of the drive sprockets	Contact Antunes Technical Service for assistance.
	Motor Drive Chain loose	Contact Antunes Technical Service for assistance.
	Internal part /object interfering within conveyor system	Check for interference & clear up as necessary.
Conveyor(s) skips or hesitates	Conveyor chains loose.	Measure and adjust the conveyor belt chains as described in the Maintenance section of this manual.
	Belt wrap clip not attached.	Verify both clips on each belt wrap are attached, reattach if necessary.
	Roller tensioner not adjusted properly.	Measure the roller tensioner and adjust if necessary. See the Maintenance section of this manual.
	Loose or misaligned sprocket	Contact Antunes Technical Service for assistance.
	Motor drive chain loose or stretched	Contact Antunes Technical Service for assistance.
	Drive motor(s) have failed	Contact Antunes Technical Service for assistance.
Buns not toasting adequately	Compression settings are incorrect.	Use recommended setting or adjust compression knobs as needed to achieve desired toast quality.
	Release sheet is worn or needs cleaning.	Inspect release sheet for cleanliness, worn spots, wrinkles, or tears. Clean or replace release sheet as described in the Maintenance section of this manual.
	Platen has butter (if butter wheel is present)/debris buildup.	Clean Platen as described in the Maintenance section of this manual.
	Light/Dark setting needs to be adjusted.	Adjust light/dark setting. See Operation section of this manual.
Crowns and/or Heels must be forced into the toaster. Buns sticking and burning.	Belt wraps are dirty, worn or damaged.	Clean or replace Belt Wraps as described in the Maintenance section of this manual.
	Platen has butter/debris buildup.	Clean Platen as described in the Maintenance section of this manual.
	Release sheet is dirty, worn or damaged.	Clean both sides or replace release sheet as described in the Maintenance section of this manual.
	Conveyor Chains loose.	Adjust the conveyor belt chains as described in the Maintenance section of this manual.
	Drive motor stalls intermittently.	Contact Antunes Technical Service for assistance.
	Compression settings are incorrect.	Use the recommended settings or adjust as needed to achieve desired toast quality.
	Buns are not inserted into the toaster properly.	Insert Crowns in front conveyor with and Heels in rear conveyor. Cut side of buns need to face the platen.

# VERTICAL CONTACT TOASTER

## TROUBLESHOOTING (CONTINUED)

Problem	Possible Cause	Corrective Action
Toaster making unusual sounds	Fan needs to be cleaned or replaced.	Clean fan as described in the Maintenance section of this manual or contact Antunes Technical Service for assistance.
	Conveyor belt chains have stretched or adjusted incorrectly.	Adjust the conveyor belt chains as described in the Maintenance section of this manual.
	Motor Drive chain needs lubrication.	Lubricate chain.
	Conveyor shaft bearing is binding.	Contact Antunes Technical Service for assistance.
Buns getting caught in bun chute area	Bun chute installed incorrectly	Reinstall Bun chute correctly.
Toaster displays ERR 10.	Internal temperature of control compartment exceeded 160° F.	Verify fan intake on back of toaster is clean, not blocked and has proper spacing. Clean cooling fan if needed, if not rotting, contact Antunes Technical Service. Check if cooling fan is functioning. If not, replace fan..

## REPLACEMENT PARTS



# VERTICAL CONTACT TOASTER

## REPLACEMENT PARTS (CONTINUED)

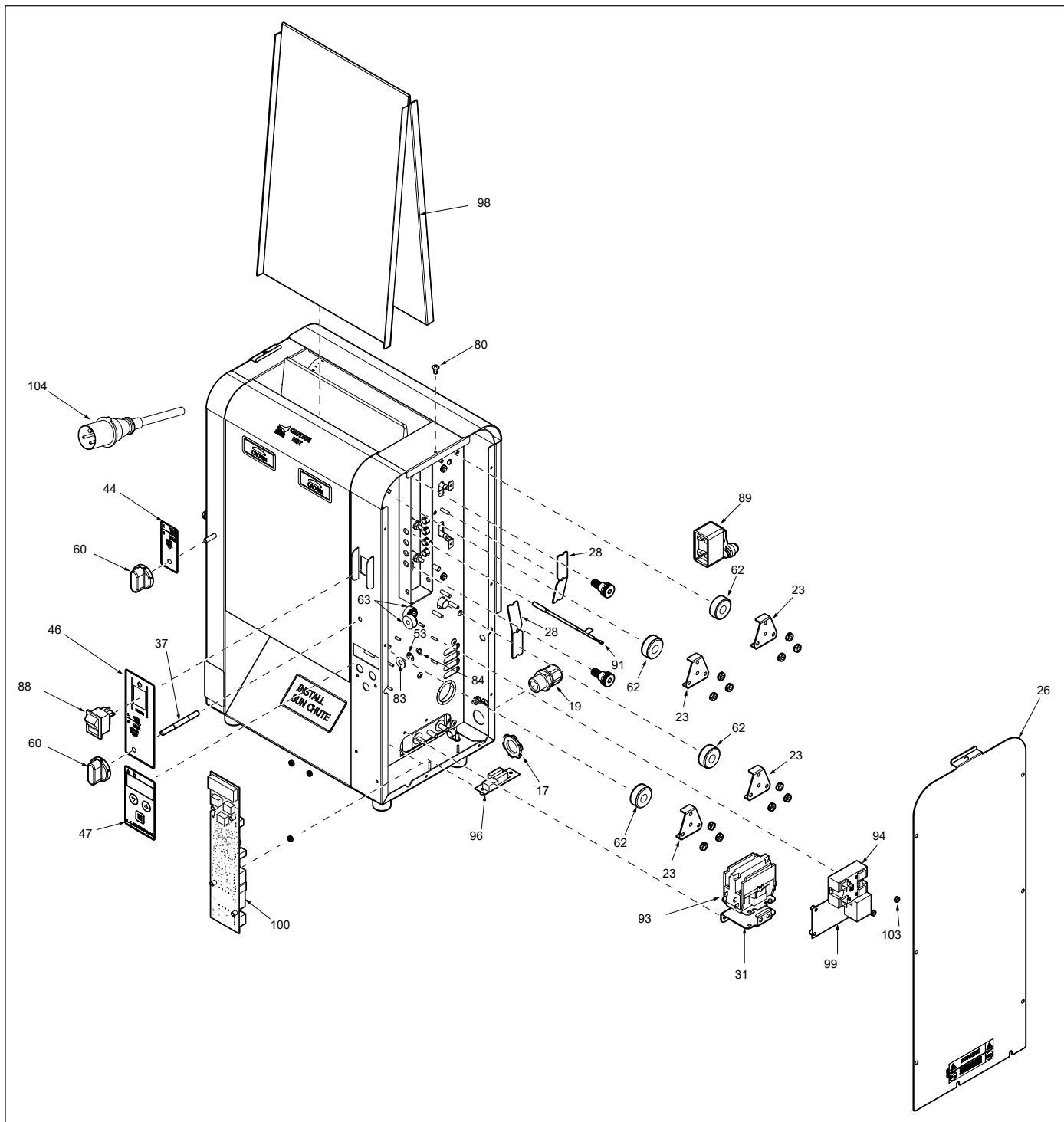

# VERTICAL CONTACT TOASTER

## REPLACEMENT PARTS (CONTINUED)

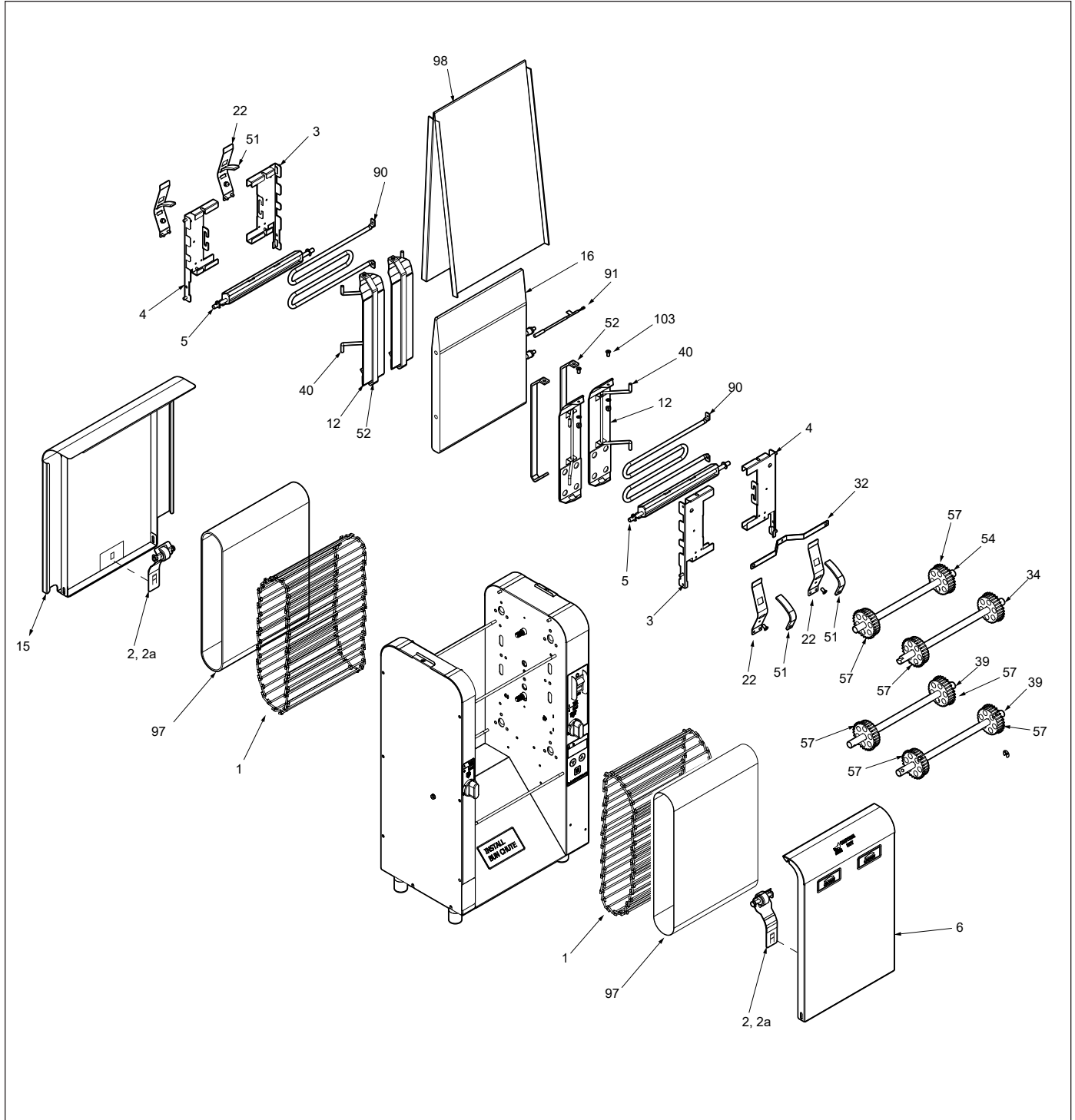

# VERTICAL CONTACT TOASTER

## REPLACEMENT PARTS (CONTINUED)

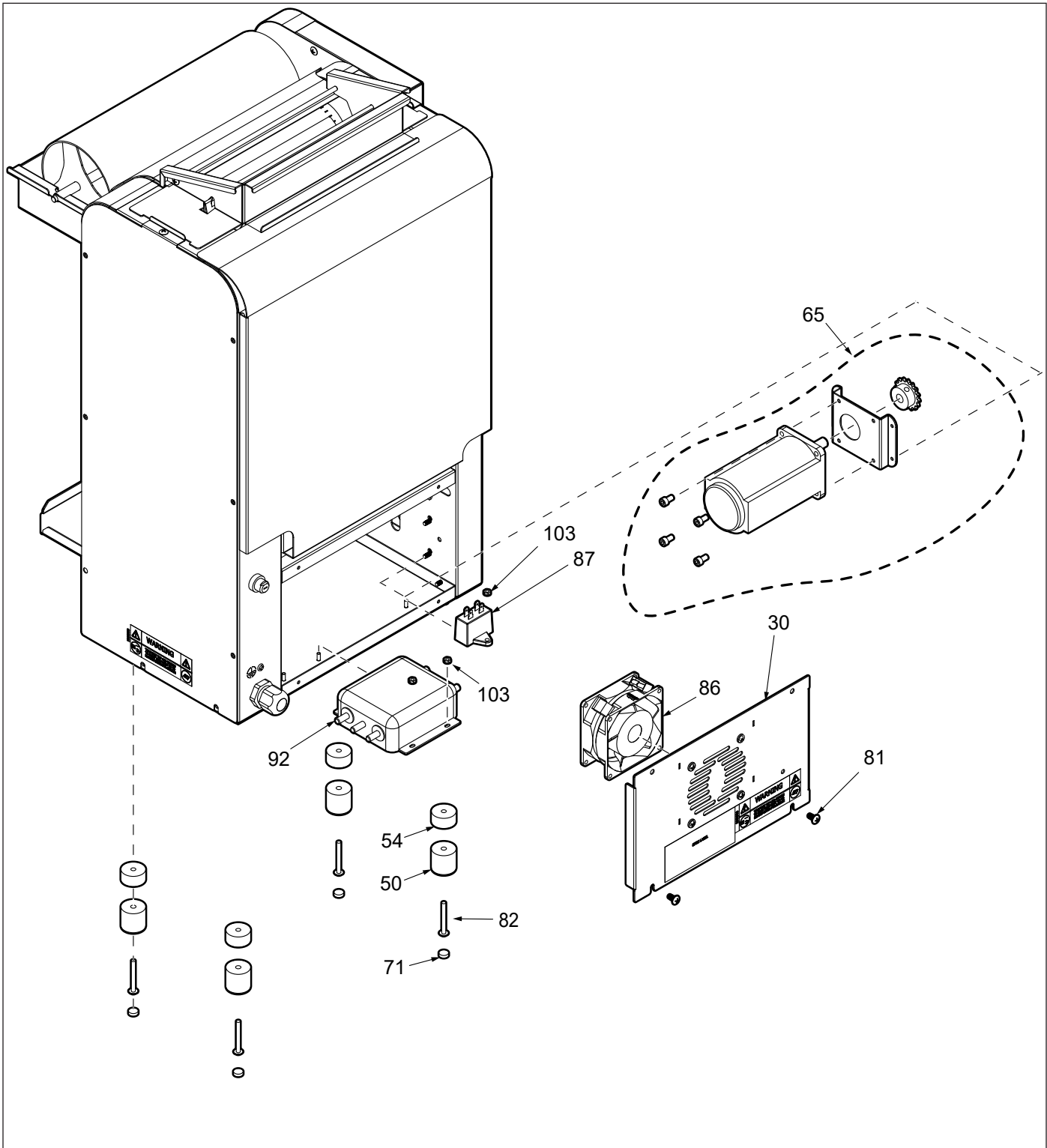



# VERTICAL CONTACT TOASTER

## REPLACEMENT PARTS (CONTINUED)

Item	Part No.	Description	Qty.
1	7001135	Conveyor Belt Assembly 37/2	2
2	7001593	Roller Tensioner Assembly	2
2a	0013373	Roller Tensioner Assembly	2
3	0022694	Tensioner Bracket Weldment - Right	2
4	0507840	Tensioner Bracket Weldment - Left	2
5	0021959	Cam Weldment	2
6a	7001269	Conveyor Cover Weldment (Mfg. No. 9210914 Only)	1
6b	7001526	Conveyor Cover Weldment (Mfg. No. 9210916 Only)	2
6c	0021961	Conveyor Cover Weldment (Mfg. No. 9210959, 9210960 & 9210983 Only)	2
7	7001540	Bun Chute Weldment	1
8	0022194	End Hsg Weldment	1
9	0022195	Control Housing Weldment	1
10	0022295	Base Weldment	1
11	7001734	Bun Feeder Accessories Kit	1
12	0024060	Weldment, Slide Shield - Crown	2
13	0506767	Weldment, Slide Shield - Heel	2
14	7001266	Weldment, Butter Wheel Roller (Mfg. No. 9210914 Only)	1
15	7001270	Weldment, Conveyor Cover Rear (Mfg. No. 9210914 & 9210916 only)	1
16	7001268	Platen, Grill 200V/1900W	1
17	040P138	Lock-Nut, Conduit-1/2" Npt	1
18	040P265	Bushing, Shorty 3/8"	4
19	0400315	Strain Relief-Cord Connector	1
20	0400432	Bushing, Open/Closed	1
21	0504321	Spacer 0.503 X 0.69 X 0.06"	1
22	0507842	Spring, Inner Tensioner	4
23	7001006	Retainer, Bearing	5
24	0507327	Butter Wheel Housing (Mfg. No. 9210914 Only)	1
25	0507500	Retainer, Bearing	1
26	7001532	Panel, Control (Mfg. No. 9210916, 9210959, 9210960 & 9210983 Only)	1
27	0507508	Panel, End Housing (Mfg. No. 9210914 Only)	1
28	0507509	Aux. Heater Retainer Clip	2
29	7001265	Pan, Butter (Mfg. No. 9210914 Only)	1
30	0507556	Panel, Electrical	1
31	0507557	Bracket, Contactor	1
32	0507558	Bracket, Thermocouple	1
33	7001529	Drive chain Tensioner	1
34	2150414	Idle Shaft (only for 9210914)	1
35	0600143	Spring, Compression Setting	1
36	7001393	Rod, Knob (Heel)	1
37	0800457	Rod, Knob (Crown)	1
38	0800458	Rod, Support	4
39	0800460	Shaft, Drive	2
40	0800900	Rod, Pivot, 3/16 O.d.	2
41	100P900*	Label - Warning	1

Item	Part No.	Description	Qty.
42	1001181	Label, Crown (Mfg. No. 9210916, 9210959, 9210960 & 9210983 only)	2
43	1001551	Label, Install	1
44	1001552	Label, Cam (Heel)	1
45a	1002662	Label, Wiring Diagram (mfg. No. 9210914 & 9210916 only)	1
45b	1001665	Label, Wiring Diagram (Mfg. No. 9210959, 9210960 & 9210983 only)	1
46	1002654	Label, Crown Compression	1
47	1002696	Label, Control	1
48a	1031295	Spec Label Mfg. No. 9210914	1
48b	1031297	Spec Label Mfg. No. 9210916	1
48c	1031369	Spec Label Mfg. No. 9210959	1
48d	1031373	Spec Label Mfg. No. 9210960	1
48e	1031503	Spec Label Mfg. No. 9210983	1
49	2070135	Coupler (Mfg. No. 9210914 Only)	4
50	210K230	Bumper, Recess W/Washer	4
51	7001600	Rail, Slide	4
52	2100379	Rail, Slide	2
53	211P127	Ring, Retaining	4
54	2120147	Spacer	4
55	7001537	Drive Sprocket Kit	1
56	7001330	Chain, Drive	1
57	7000207	Sprocket, 25B28 1/2" Bore Stepped Tooth	8
58	2150212	Sprocket, 25B12 1/2" Bore (Mfg. No. 9210914 Only)	1
59	2150214	Sprocket, 25B30, 1/2" Bore (Mfg. No. 9210914 Only)	1
60	7001531	Push on Knob Kit	1
61	2150251	Sprocket, 25B14 3/8" Bore	1
62	7000296	Bearing Kit	6
63	2150368	Miter Gear	4
64	2150401	Chain, Drive (64 Links) (Mfg. No. 9210914 Only)	1
65	7001530	Motor, 230V	1
66	7001115	Idle Bearing Retainer	1
67	2150415	Coupler	1
68	7000296	Bearing, 1/2IDx1-1/8OD	1
69	2150419	Shaft Idler with Pin (Mfg. No. 9210914 Only)	1
70	2150420	Shaft, Drive (Mfg. No. 9210914 Only)	1
71	218P145*	Cover, Bumper	4
72	300P124*	Ring, Retaining 3/8"	1
73	303P115*	Cotter Pin-1/16"	1
74	303P133*	Pin, Clevis	1
75	306P102*	Washer, Int. Tooth #6	1
76	306P105*	Screw, Mach. #6-32 X 1/2"	1
77	308P115*	Screw, Mach. #8-32 X 9593/8"	1
78	308P124*	Screw, Mach One-Way #8-32	1
79	308P143*	Nut, Hex 'Keps' #8-32	1
80	308P157*	Screw, Tap 8-32 X 3/8"Lg	1

# VERTICAL CONTACT TOASTER

## REPLACEMENT PARTS (CONTINUED)

Item	Part No.	Description	Qty.
81	308P203*	Screw, Tap 8-32 X 3/8" W/Int. Tooth Washer	1
82	3080341	Screw, #8-32 X 1.5 LG	4
83	325P104*	Washer, Flat 1/4" S/S	1
84	325P203*	Washer, Spring Steel Single-Wave	1
85	0500464	Bearing Spacer	1
86	7001440	Fan, Axial - 230V, Metal Housing & Imp	1
87	7001527	Cap-Mp, Motor Run	1
88	7001580	Switch, Rocker	1
89	7001144	Thermostat, Hi-Limit 700°F	1
90	7001259	Aux Heater, 200Vac, 550W (Mfg. no. 9210914, 9210916 Only)	2
91	7001293	Thermocouple Type "K" (Open End)	1
92	7001428	Line Filter (Mfg. no. 9210914, 9210916 9210959 & 9210983 Only)	1
93	7001017	Contactor, 2 Pole No	1
94	7001142	Relay, Solid State Dual Pole W/Conn-Recept	1
95	4060466	C-Clip (Mfg. No. 9210914 Only)	4
96	7001429	Varistor Board	1
97	7001158	Black Wavy Cleated Silicone Belt Wrap (Mfg. no. 9210914, 9210916 Only)	1
98	7001168	Platen Cover Sheet (3 pack)	1
99	7001261	Asy-PCB, VCT Mini Power Board	1
100	7001260	Asy-PCB, VCT Mini Control Board	1
101	3100228	SCR, SHLDR #10-32 x 1.125	1
102	7001267	End Housing Cover Assy. (Mfg. No. 9210914 Only)	1
103	306P130*	Nut, Hex keps #06-32 Steel; Zinc Plated	1
104a	0700982	Power Cord (Mfg. no. 9210914, 9210916 & 9210959 Only)	1
104b	0700976	Power Cord (Mfg. No 9210960 Only)	1
104c	0700694	Power Cord (Mfg. No. 9210983 Only)	1
105	211P127	Retainer Ring	4
106	7001595	Sprocket, 25B14 ½ Bore	1
* Items available in packages of 10 (Ten)			

## WIRING DIAGRAM

# WIRING DIAGRAM

## WIRE LEGEND

- 12 GA XLPE
- 14 GA TEF
- # 18 GA PVC
- 20 GA XLPE
- △ 22 GA TFE
- 22 GA XLPE
- ① WIRE NUMBER

208/240V  
50/60HZ  
3000W MAX

GRN/YEL

MOV

LF1

L1 ○ BLK ①

L2 ② ○ WHT

SW1

POWER

③ # BLK

④ # WHT

⑤ # WHT

⑥ # WHT

⑦ # WHT

⑧ # WHT

⑨ # WHT

⑩ # WHT

⑪ # WHT

⑫ # WHT

⑬ # WHT

⑭ # WHT

⑮ # WHT

⑯ # WHT

⑰ # WHT

⑱ # WHT

⑲ # WHT

⑳ # WHT

㉑ # WHT

㉒ # WHT

㉓ # WHT

㉔ # WHT

㉕ # WHT

㉖ # WHT

㉗ # WHT

㉘ # WHT

㉙ # WHT

㉚ # WHT

㉛ # WHT

㉜ # WHT

㉝ # WHT

㉞ # WHT

㉟ # WHT

㊱ # WHT

㊲ # WHT

㊳ # WHT

㊴ # WHT

㊵ # WHT

㊶ # WHT

㊷ # WHT

㊸ # WHT

㊹ # WHT

㊺ # WHT

㊻ # WHT

㊼ # WHT

㊽ # WHT

㊾ # WHT

㊿ # WHT

① BLK

② BLK

③ BLK

④ BLK

⑤ BLK

⑥ BLK

⑦ BLK

⑧ BLK

⑨ BLK

⑩ BLK

⑪ BLK

⑫ BLK

⑬ BLK

⑭ BLK

⑮ BLK

⑯ BLK

⑰ BLK

⑱ BLK

⑲ BLK

⑳ BLK

㉑ BLK

㉒ BLK

㉓ BLK

㉔ BLK

㉕ BLK

㉖ BLK

㉗ BLK

㉘ BLK

㉙ BLK

㉚ BLK

㉛ BLK

㉜ BLK

㉝ BLK

㉞ BLK

㉟ BLK

㊱ BLK

㊲ BLK

㊳ BLK

㊴ BLK

㊵ BLK

㊶ BLK

㊷ BLK

㊸ BLK

㊹ BLK

㊺ BLK

㊻ BLK

㊼ BLK

㊽ BLK

㊾ BLK

㊿ BLK

① WHT

② WHT

③ WHT

④ WHT

⑤ WHT

⑥ WHT

⑦ WHT

⑧ WHT

⑨ WHT

⑩ WHT

⑪ WHT

⑫ WHT

⑬ WHT

⑭ WHT

⑮ WHT

⑯ WHT

⑰ WHT

⑱ WHT

⑲ WHT

⑳ WHT

㉑ WHT

㉒ WHT

㉓ WHT

㉔ WHT

㉕ WHT

㉖ WHT

㉗ WHT

㉘ WHT

㉙ WHT

㉚ WHT

㉛ WHT

㉜ WHT

㉝ WHT

㉞ WHT

㉟ WHT

㊱ WHT

㊲ WHT

㊳ WHT

㊴ WHT

㊵ WHT

㊶ WHT

㊷ WHT

㊸ WHT

㊹ WHT

㊺ WHT

㊻ WHT

㊼ WHT

㊽ WHT

㊾ WHT

㊿ WHT

① RED

② RED

③ RED

④ RED

⑤ RED

⑥ RED

⑦ RED

⑧ RED

⑨ RED

⑩ RED

⑪ RED

⑫ RED

⑬ RED

⑭ RED

⑮ RED

⑯ RED

⑰ RED

⑱ RED

⑲ RED

⑳ RED

㉑ RED

㉒ RED

㉓ RED

㉔ RED

㉕ RED

㉖ RED

㉗ RED

㉘ RED

㉙ RED

㉚ RED

㉛ RED

㉜ RED

㉝ RED

㉞ RED

㉟ RED

㊱ RED

㊲ RED

㊳ RED

㊴ RED

㊵ RED

㊶ RED

㊷ RED

㊸ RED

㊹ RED

㊺ RED

㊻ RED

㊼ RED

㊽ RED

㊾ RED

㊿ RED

① ORG

② ORG

③ ORG

④ ORG

⑤ ORG

⑥ ORG

⑦ ORG

⑧ ORG

⑨ ORG

⑩ ORG

⑪ ORG

⑫ ORG

⑬ ORG

⑭ ORG

⑮ ORG

⑯ ORG

⑰ ORG

⑱ ORG

⑲ ORG

⑳ ORG

㉑ ORG

㉒ ORG

㉓ ORG

㉔ ORG

㉕ ORG

㉖ ORG

㉗ ORG

㉘ ORG

㉙ ORG

㉚ ORG

㉛ ORG

㉜ ORG

㉝ ORG

㉞ ORG

㉟ ORG

㊱ ORG

㊲ ORG

㊳ ORG

㊴ ORG

㊵ ORG

㊶ ORG

㊷ ORG

㊸ ORG

㊹ ORG

㊺ ORG

㊻ ORG

㊼ ORG

㊽ ORG

㊾ ORG

㊿ ORG

① BLK

② BLK

③ BLK

④ BLK

⑤ BLK

⑥ BLK

⑦ BLK

⑧ BLK

⑨ BLK

⑩ BLK

⑪ BLK

⑫ BLK

⑬ BLK

⑭ BLK

⑮ BLK

⑯ BLK

⑰ BLK

⑱ BLK

⑲ BLK

⑳ BLK

㉑ BLK

㉒ BLK

㉓ BLK

㉔ BLK

㉕ BLK

㉖ BLK

㉗ BLK

㉘ BLK

㉙ BLK

㉚ BLK

㉛ BLK

㉜ BLK

㉝ BLK

㉞ BLK

㉟ BLK

㊱ BLK

㊲ BLK

㊳ BLK

㊴ BLK

㊵ BLK

㊶ BLK

㊷ BLK

㊸ BLK

㊹ BLK

㊺ BLK

㊻ BLK

㊼ BLK

㊽ BLK

㊾ BLK

㊿ BLK

① WHT

② WHT

③ WHT

④ WHT

⑤ WHT

⑥ WHT

⑦ WHT

⑧ WHT

⑨ WHT

⑩ WHT

⑪ WHT

⑫ WHT

⑬ WHT

⑭ WHT

⑮ WHT

⑯ WHT

⑰ WHT

⑱ WHT

⑲ WHT

⑳ WHT

㉑ WHT

㉒ WHT

㉓ WHT

㉔ WHT

㉕ WHT

㉖ WHT

㉗ WHT

㉘ WHT

㉙ WHT

㉚ WHT

㉛ WHT

㉜ WHT

㉝ WHT

㉞ WHT

㉟ WHT

㊱ WHT

㊲ WHT

㊳ WHT

㊴ WHT

㊵ WHT

㊶ WHT

㊷ WHT

㊸ WHT

㊹ WHT

㊺ WHT

㊻ WHT

㊼ WHT

㊽ WHT

## WIRING DIAGRAM

MFG No. 9210959, 9210960 & 9210983

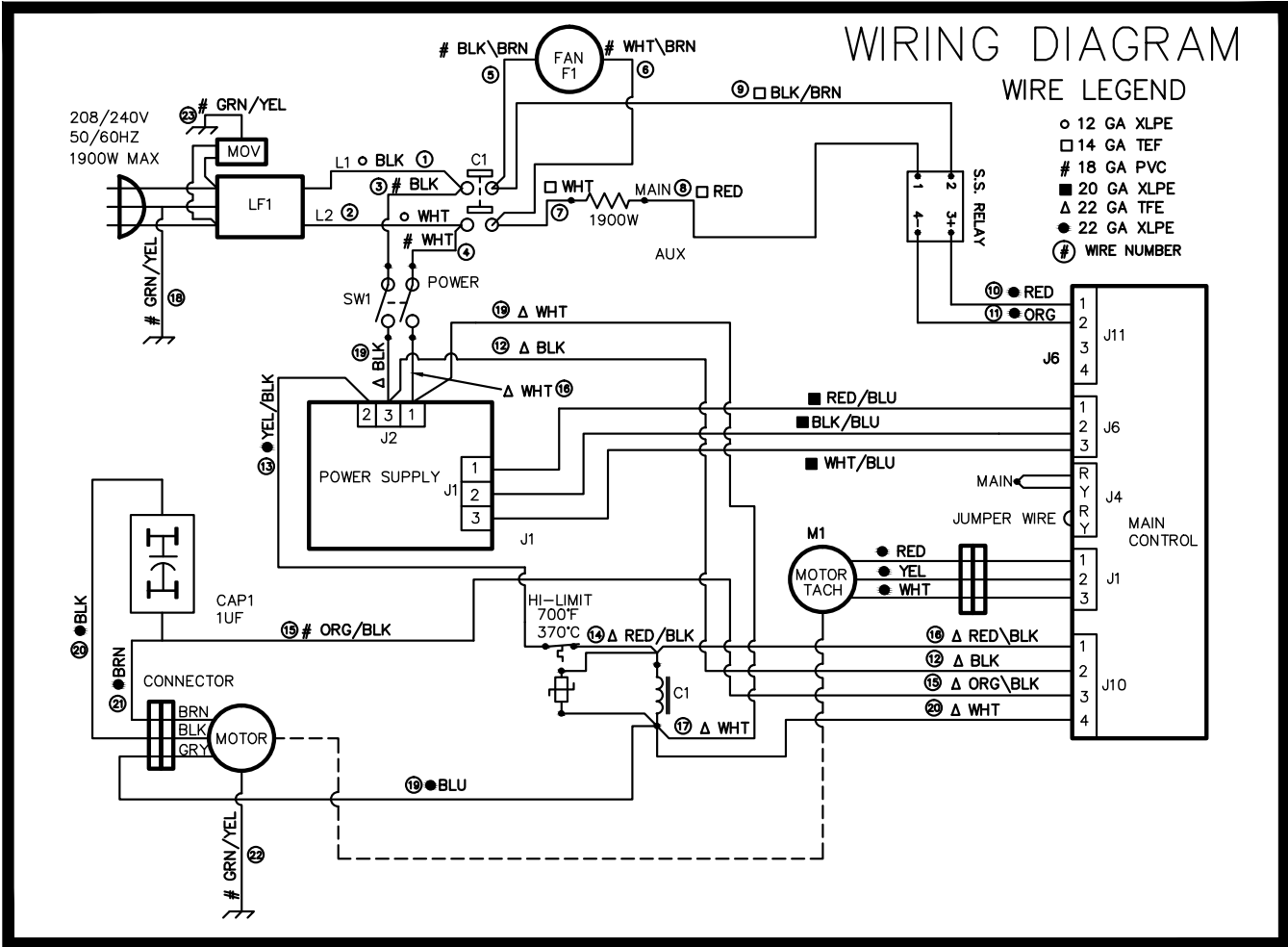

NOTES

[illegible]

## VERTICAL CONTACT TOASTER

## NOTES

[illegible]



**Corporate Headquarters**

Carol Stream, Illinois

Phone: +1 (630) 784-1000

Toll Free: +1 (800) 253-2991

Fax: +1 (630) 784-1650

**China Facility**

Suzhou, China

Phone: +86-512-6841-3637

Fax: +86-512-6841-3907