

VCT CONVEYOR BELT CHAIN CLEANING INSTRUCTIONS

⚠ WARNING ⚠

Turn the unit off, unplug the power cord, and allow the unit to cool down before performing service or maintenance on the unit.

AFFECTED PRODUCTS: *Vertical Contact Toasters*

ITEMS REQUIRED:

- 1 - Clean Scouring Pad
- 1 - Sanitizer Solution
- 1 - Clean, sanitizer soaked towel

Link to Instructional Video

To access an instructional video of these procedures, please visit <https://youtu.be/AV2ip8jvq0U> or scan the QR code below:



General

These instructions are meant to guide restaurant personnel through proper maintenance of the Conveyor Belt Chains. Please contact Antunes Technical Service at +1-877-392-7854 with any questions or concerns regarding this procedure.

NOTE: It is normal for the PTFE slide rails and spring tensioners to wear during the “break-in” period as shown in Fig 1. The PTFE material is food grade and FDA approved but does require cleaning as part of scheduled maintenance.

1. Turn the unit off, unplug the power cord, and allow the unit to cool down.
2. Put on heat resistant gloves. Remove the Bun Feeder, Bun Chute (if present), and Heat Shield (Figure 2). Set these items aside.
3. Open the front conveyor Cover by lifting the cover up and away from the toaster (Figure 2). If unit has belt wraps, remove them before proceeding to step 4. See instructions on page 3-4 of this document if needed.
4. Plug in the power cord and turn the unit on.
5. Using a scouring pad soaked with sanitizer solution, wipe the links of the front Conveyor Belt Chain firmly from side to side (Figure 3) and from top to bottom. Also wipe each link of the chain side to side (Figure 4). Rotate the belt by pressing the Interlock Safety Switch on the top of the unit (Figure 5). Rotate and clean the belt until it is completely free of residue and debris.

6. Use a clean, sanitizer soaked towel to wipe the front Conveyor Belt Chain from side to side until the entire belt is wiped clean (Figure 6)
7. Repeat Steps 3 through 5 on the rear Conveyor Belt Chain.
8. Reinstall the Bun Feeder, Heat Shield, and Bun Chute (if present). Plug in the power cord and turn the unit on. Test the unit for proper operation.

NOTE: Be sure the Bun Chute is free of PTFE “flakes” before reinstalling the Bun Chute.

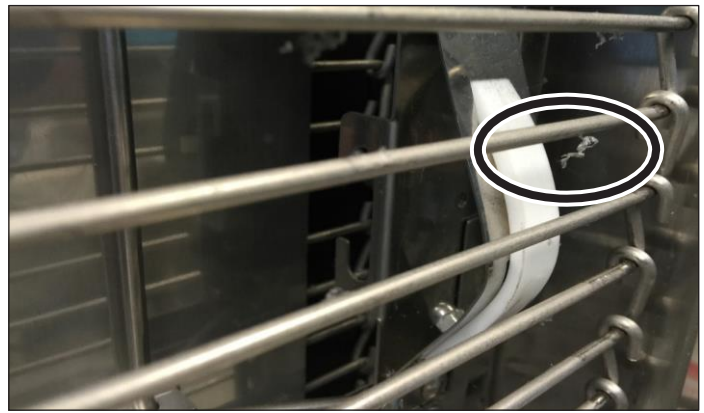

Figure 1. PTFE on Conveyor Belt Chain Link

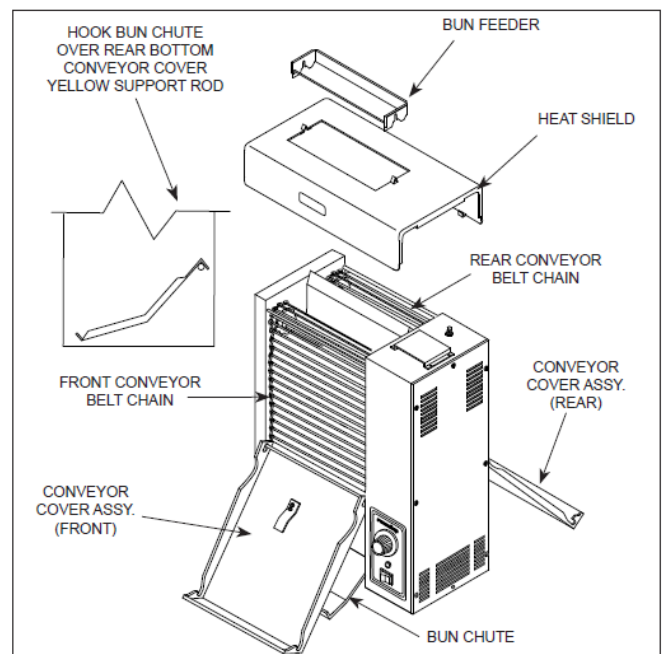

Figure 2. Toaster Components

VCT CONVEYOR BELT CHAIN CLEANING INSTRUCTIONS



Figure 3. Cleaning Conveyor Belt Chain



Figure 5. Conveyor Interlock Safety Switch



Figure 4. Cleaning Conveyor Belt Chain Link



Figure 6. Sanitizing Conveyor Belt Chain

INSTALLING CLIP STYLE BELT WRAPS

General

This addendum describes how to install the new clip style belt wraps (P/N 7000964) on the VCT-2000 toaster.

If you experience any problems with these instructions, contact the factory Technical Service Department at 630-784-1000 or toll free in the U.S. at 877-392-7854.

Installation

1. With power off and toaster cool, set crown and heel compression knobs to 6 & F. Remove top cover and both conveyor covers. Remove current belts by either removing lacing pin or using scissors or razor knife, carefully cut the belt free of the wire, drive belt. NOTE: Check conveyers chains for proper tension and remove a link if necessary (see owners manual for instructions).



2. Before installing new conveyor belt wraps, wipe conveyers chain links with sanitized towel (see owners manual for instructions). Pick belt up from the center and feed flap end beneath yellow bar and lower belt until the other end of the belt is on the bottom of the toaster. Ensure the "Run Belt This Direction" arrow follows the same directional path as the wire belt. Feed belt from the bottom through bottom yellow bar until both ends are approximately in the middle of the toaster.



3. Starting at a conveyor link in approximately the middle of the conveyor chain, attach the top hook of each clip to a conveyor link and gently push the belt downward to attach the bottom of the clip to the link directly below the top hook. NOTE: There are 2 different size conveyor links, ensure the clips are attached to the larger 3/4" links, do not attached to small 1/2" links.



INSTALLING CLIP STYLE BELT WRAPS

4. Verify both clips on the belt wraps are secured to the links on the conveyor chains. Then position both ends of the new belt together and line up so the lacing is even. Insert the pin to join both sides of the belt together.
5. Verify belt alignment is even from side to side of each belt. Reinstall both conveyor covers and top cover. NOTE: Ensure roller tensioners are adjusted per manufacture specifications. (See owners manual.)

