

Mod. **ZO201PAL**

RF42VLXEHHG10AAC1A

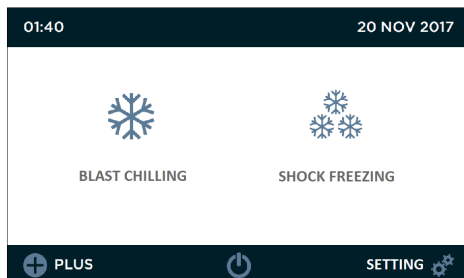

FUNCTIONS:

Blast Chilling
Shock Freezing

GENERAL FEATURES:

Panel construction
Stainless steel exterior (Scotch-Brite satin)
Inner in stainless steel with rounded corners
Inside bottom and floor die-formed leakproof
Insulation in high density (42 kg/m³ approx.) expanded polyurethane, 80 mm thick, HCFC-free
Copper-aluminum evaporator with cataphoresis anti-corrosion treatment
High-ventilation evaporator to ensure the highest efficiency of the cooling system
Anti-condensation resistance, placed on the door under the gasket
Hinged door with gasket and closing ramp system
Ergonomic full-height door handle
Access ramp with liquid collection grid and filtering system (optional)

INTERNAL SETUP:

Thick stainless steel internal bumper to avoid damage caused by the trolley
Heated core probe, with 4 measuring points
Pre-cooling function
Automatic storing at end of blast chilling
Indirect blowing electronic fans, efficient but gentle on food

COOLING SYSTEM:

Condensing unit on board with air cooling
R452A ecological refrigerant fluid

CONTROLS AND SAFETY DEVICES:

5" high-definition IPS capacitive TOUCH display, easy to use
USB connection for uploading and downloading data and recipes
Circuit breaker for compressor protection
Class NT (ambient temperature + 38 ° C)

VERSIONS / ACCESSORIES (OPTIONALS):

Predisposition for other gas variants

Mod. ZO201PAL

RF42VLXEHHG10AAC1A

MODELLO:		ZO201PAL
NET WIDTH	mm	890
NET DEPTH	mm	1350
NET HEIGHT	mm	2400
NET WEIGHT	Kg	600
PACKED WIDTH	mm	1150
PACKED DEPTH	mm	1550
PACKED HEIGHT	mm	2590
PACKED WEIGHT	Kg	720
PACKED VOLUME	m ³	5.31
NET HEIGHT DOOR	mm	1820
DOOR OPENING WIDTH	mm	680
INNER DEPTH	mm	830
INSULATION THICKNESS	mm	80
FLOOR HEIGHT	mm	60
N° OF COMPARTMENTS	n°	1
N° OF DOORS	n°	1
POWER SUPPLY		380-420/3/50 + N
LOADING CAPACITY n° TRAYS GN	n°	1 TROLLEY GN1/1
LOADING CAPACITY n° TRAYS EN	n°	1 TROLLEY GN1/1
CHILLING CAPACITY	Kg	60
FREEZING CAPACITY	Kg	30
REFRIGERANT	gas	R452A
NOMINAL CURRENT	A	9,03
DEFROST TYPE		Door Open
ABSORBED ELECTRICAL POWER	W	7546
COOLING POWER	W	4920
NOIS LEVEL	dB(A)	42.9

(*) For mod. BC___Evap. Temperature -10°C - Cond. temperature +40°C

(*) For mod. BF___Evap. temperature -25°C - Cond. Temperature +40°C

BLAST CHILLER FREEZER FOR TROLLEYS - PANELLED CONSTRUCTION ZOOM SERIE

LAINOX®

Mod. **ZO201PAL**

RF42VLXEHHG10AAC1A

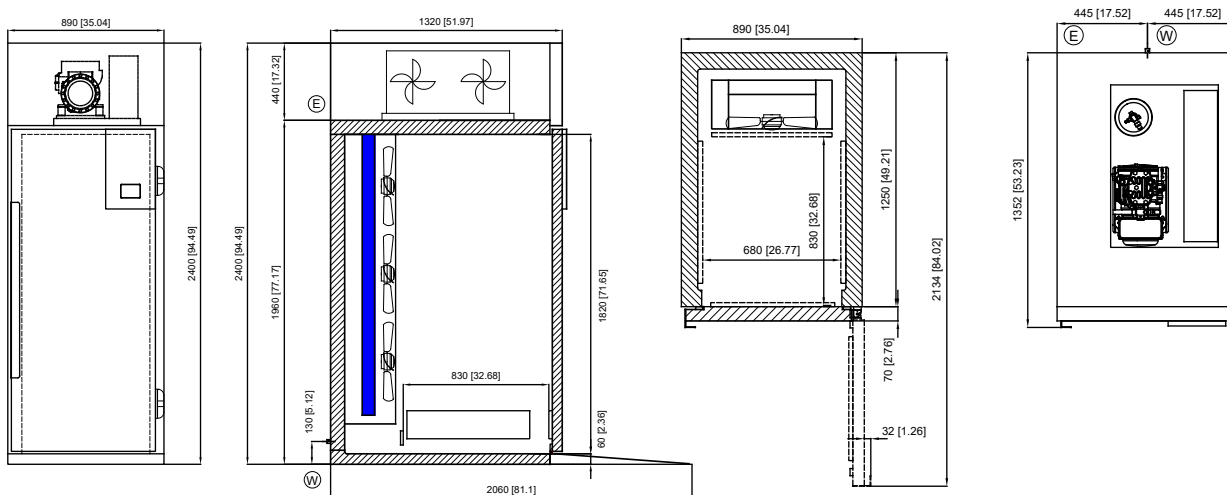

- Ⓔ CONNESSIONE ELETTRICA
ELECTRICAL CONNECTION
 - ⒲ CONNESSIONE SCARICO 1/2"
DRAIN CONNECTION 1/2"
- DIMENSIONI mm
DIMENSIONS [in]