

# MKF 611 C BM

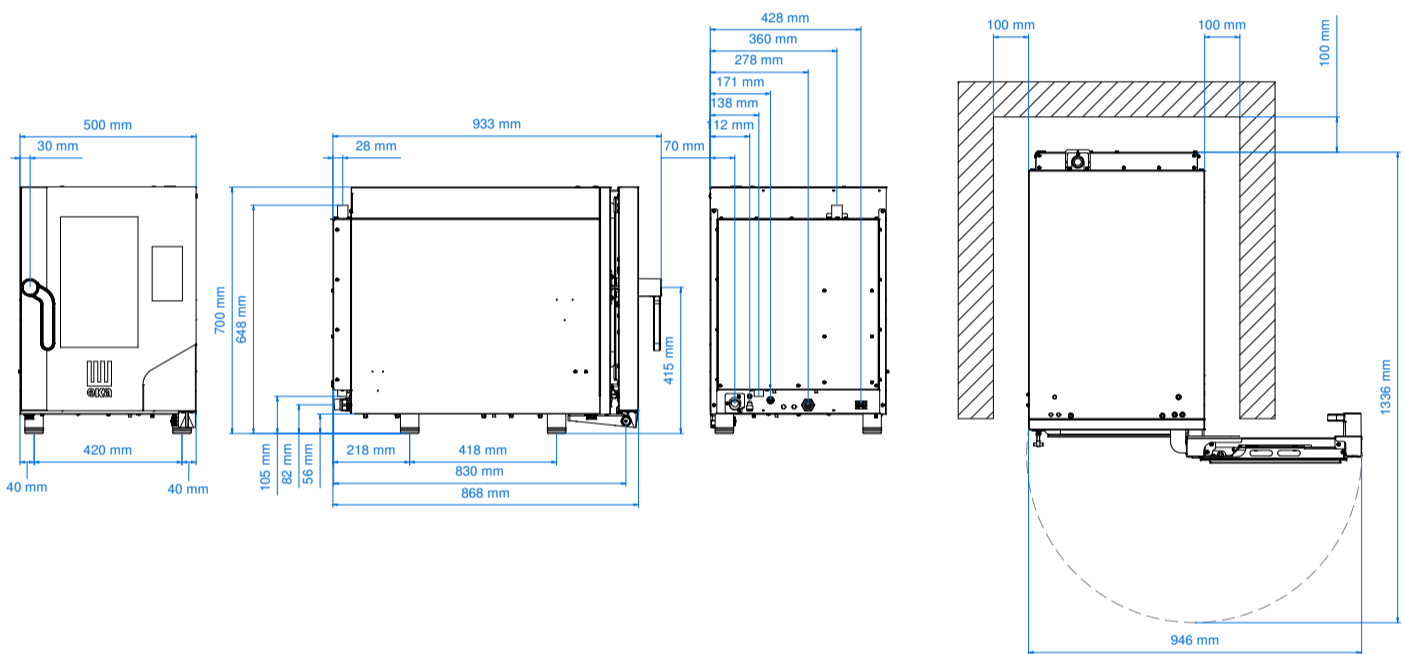

## Electric COMPACT combi oven 6 trays 1/1 GN with BLACK MASK

In just 50 cm of width, Tecnoeka offers all the cutting-edge innovations of a MILLENNIAL oven in the new oven with the BLACK MASK panel that will ensure you always achieve a high level result, even in a kitchen with limited space. Maximum efficiency in the smallest space, with the possibility of using 6 1/1 GN trays and 100 programmable recipes!



### Plus

Patented fan guard system <b>Airflowlogic™</b>
Patented system for direct steam <b>Humilogic™</b>
Available on request at the order
Humidity management software
Programmable oven start
N° 40 recipes stored
HACCP system
Adjustable door hinges

### Equipment

Cardboard box dimensions with pallet (WxDxH mm)	570 x 980 x 870
Lateral supports	1 right + 1 left
Cable	Three-phase+neutral [5G 2,5]-L=1600 mm
USB port	
Single-point core probe cod. MKSCMO	
Support for core probe cod. MKSSC/A	
Automatic washing system integrated	
Condensate collection bowl, with drain on door	
Hinge with door locking for openings adjusted at 60°, 90°, 120°, 180°	

### Optionals

Available in the dedicated section

### Dimensional features

Dimensions (WxDxH mm)	500 x 930 x 700
Weight (kg)	70,8
Distance between rack rails (mm)	68

### Electrical features

Power supply (kW)	7,8
Frequency (Hz)	50/60
Voltage (V)	AC 380/400 3N
N° motors	1 bidirectional
Boiler (kW)	/
Protection against water	IPX4

### Functional features

Power	Electricity
Capacity	N° 6 trays/grids 1/1 GN
Type of cooking	Semistatic + ventilated
Steam	Direct steam controlled by touch panel (10 levels)
Cooking chamber	AISI 304 stainless steel
Temperature	30 - 270 °C
Temperature control	Digital probe thermometer
Control panel	Black mask electronic control
N° programs	100
Programmable cooking steps	10
Pre-heating temperature	180 °C
Pre-heating function	Programmable
Door	Right side opening Ventilated Inspectionable glass
Modularity	Yes
Feet	Adjustable